

NOMA[®] PROTECT

—
WARNING
PROFILES

nmc

SOLUTIONS
FOR INDUSTRIES

A close-up photograph of two cardboard boxes resting on a yellow and black striped safety rail. The rail is curved and has a glossy finish. The boxes are made of brown cardboard. The background is blurred, showing what appears to be a warehouse or industrial setting.

SHOCK
ABSORPTION
REDEFINED.



NOMA® PROTECT WARNING PROFILES

effectively prevent dangers thanks to their striking signal colour and provide reliable impact protection through their flexibility. The high-performance adhesive used, keeps the profile in place even under difficult conditions.

NOMA® PROTECT WARNING PROFILES

PRODUCT FEATURES

- › Durable long term protection
- › Flexible PU profile, can be applied on curved surfaces
- › Permanent adhesive with excellent adhesion properties on various surfaces
- › High visibility for indication of danger zones
- › Easy to apply, no tools needed
- › Silicone-free

ENVIRONMENTS

- › Intended for dry, indoor use
- › Operational temperature -40 °C up to +100 °C

PROTECTION

- › Bumper to prevent body injuries at corners and (sharp) edges (eg: hand and head injuries)
- › Bumper to prevent damages to scratch sensitive materials
- › Bumper to protect infrastructure (walls, pillars) against trolleys and light carts

ADVISORY IMPACT

- › People bumping their head or body against corners and edges
- › Light carts and trolleys at low speed (150 kg – 5 km/h)



MATERIAL

Outer skin

Core

Adhesive

Liner

1. TPU
2. Flexible high density PU foam
3. Acrylate (solvent free)
4. Silicone-free paper film

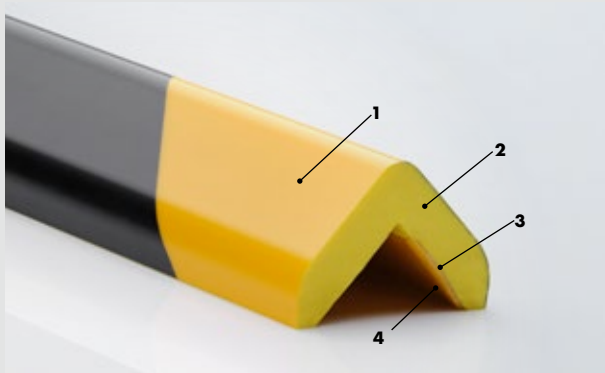

INSTALLATION

Pretreatment

Surfaces need to be clean, dry and degreased

Advised application temperature: 15 - 20 °C

Advised environment

Concrete wall or pillar

Steel rack / Metal construction

Glass edge / Glass surface

Installation instruction

Remove liner and press firmly against surface
for at least 5 seconds

SIZE, PHYSICAL AND CHEMICAL PROPERTIES

Profile length	1 m (2 m on demand)	
Surface toughness	smooth surface	
Abrasion resistance	High	
Elasticity/flexibility	High	
Density	450 - 600 kg/m ³	
Exposure to sunlight	Not intended for outdoor use	
Fire resistance	Class E	ISO 11925-2
Adhesive power	min. 35 N/25 mm	DIN EN 1939 (2003)
Hardness	50	Shore A
Salt environment	Continuous exposure	
Wet environment	Continuous exposure	
Petroleum/oil/kerosene	Limited exposure	
Benzene-toluene	Limited exposure	
Alcohols	Limited exposure (Ethanol, Methanol, Phenol)	
Alkaline solutions	Not recommended	
Acid solutions	Not recommended (Nitric acid)	
Solvents	Not recommended (Aceton, Formamide, Dimethyl sulfoxide)	

For further information about chemical resistance contact your local sales team



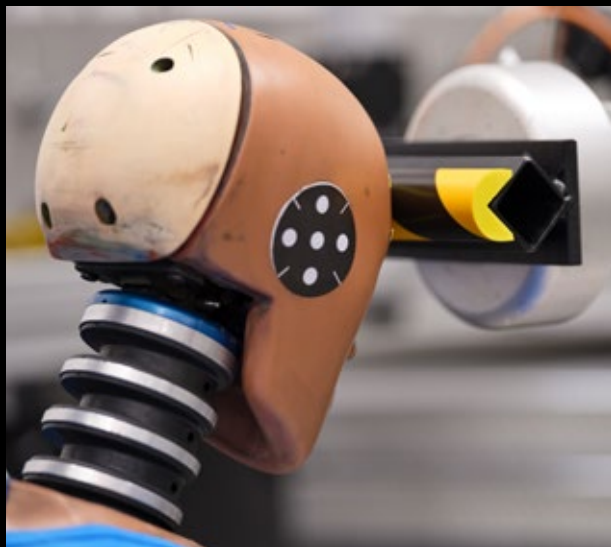

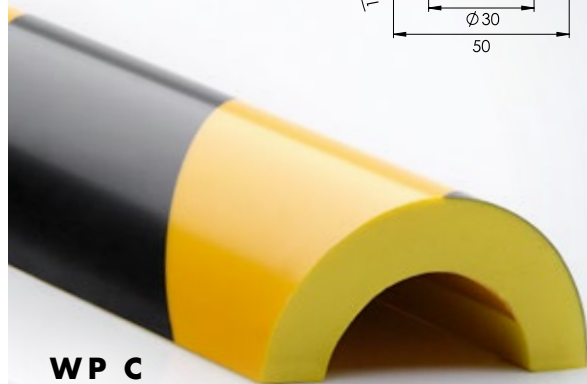
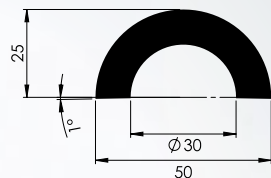
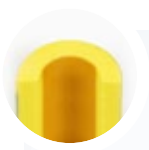

WP C
50 x 25 mm

Item Code:
3044629

Packaging unit:
6 m

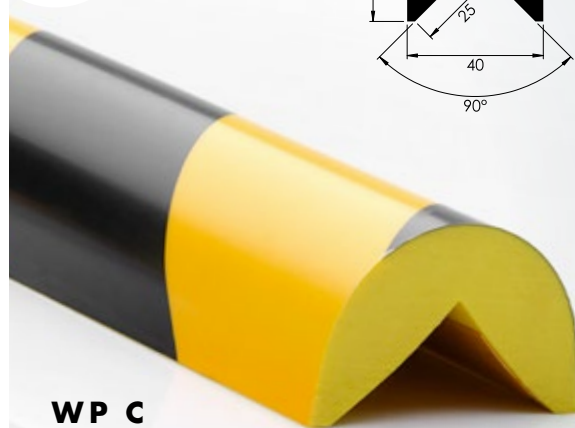
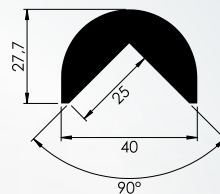
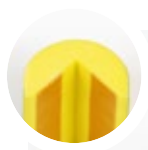

WP C
40 x 28 mm

Item Code:
3044628

Packaging unit:
6 m

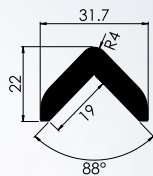
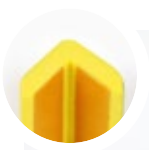

WP L
32 x 22 mm

Item Code:
3044630

Packaging unit:
12 m

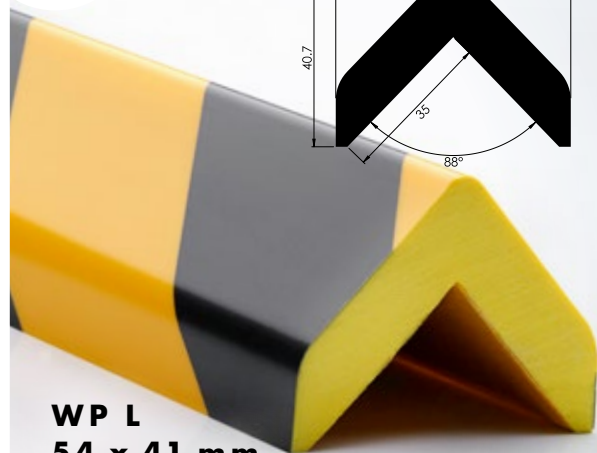
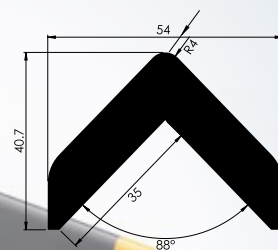
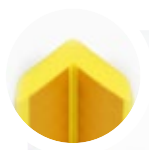

WP L
54 x 41 mm

Item Code:
3044729

Packaging unit:
6 m

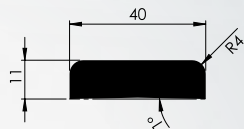
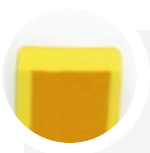

WP P
40 x 11 mm

Item Code:
3044631

Packaging unit:
12 m

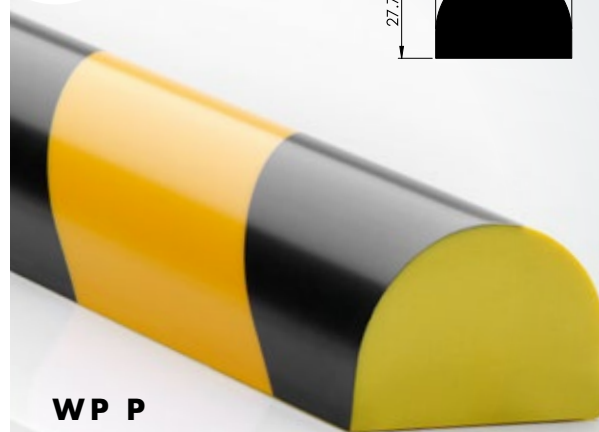
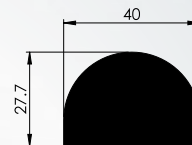
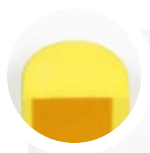

WP P
40 x 28 mm

Item Code:
3044727

Packaging unit:
6 m

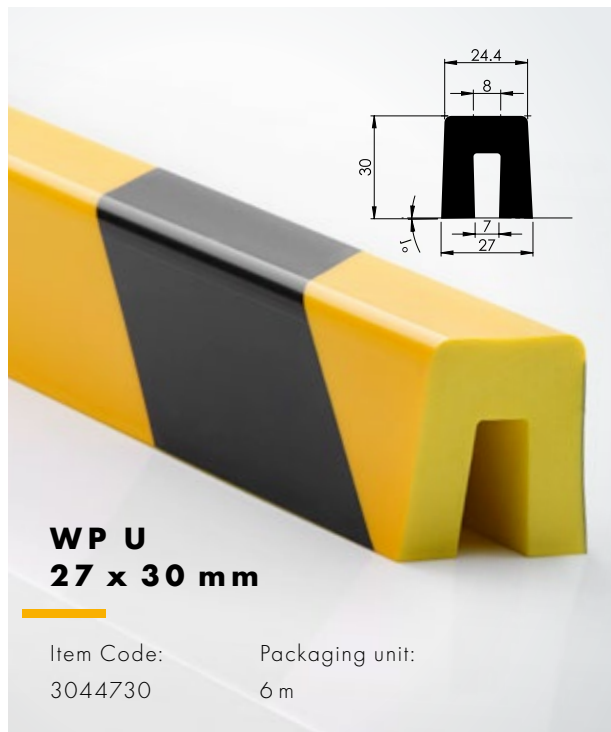

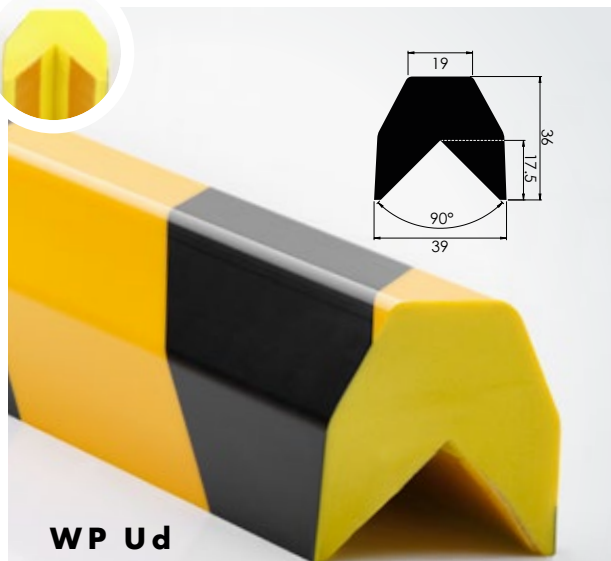
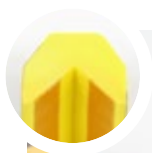

WP Ud
39 x 36 mm

Item Code:
3051532

Packaging unit:
6 m

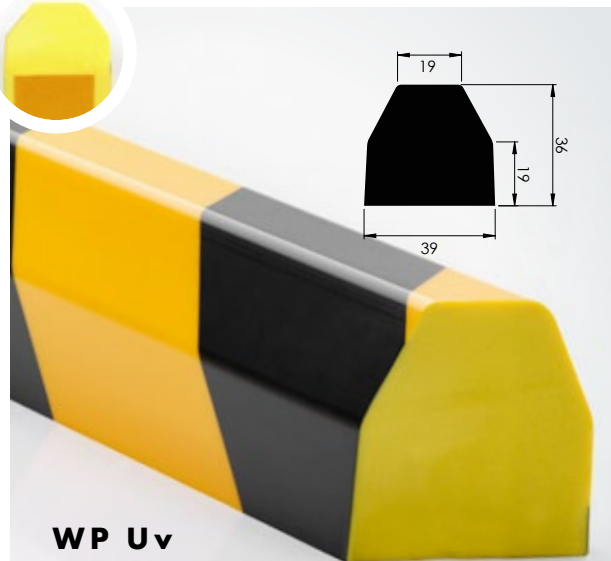
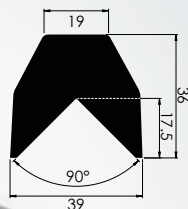

WP Uv
39 x 36 mm

Item Code:
3051531

Packaging unit:
6 m

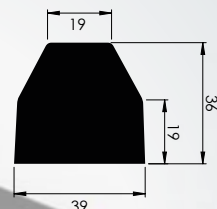



NO PROBLEM!

On special request, the
NOMA®PROTECT WARNING
PROFILES can also be printed
with customised colour patterns.

Please feel free to contact us without obligation.

REAL SIZE CROSS SECTIONS



WPL 32 x 22 mm



WPL 54 x 41 mm

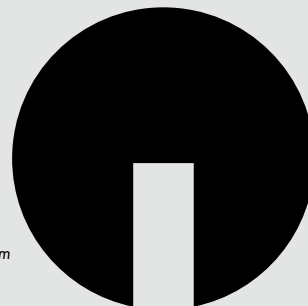

WPO 40 x 40 mm

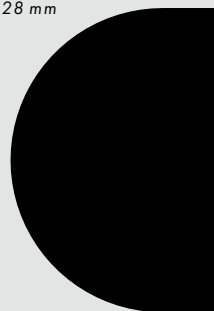

WPP 40 x 28 mm

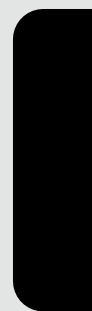

WPP 40 x 11 mm

WPC 27 x 30 mm

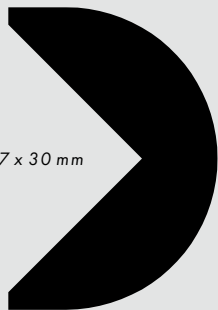

WPU 27 x 30 mm

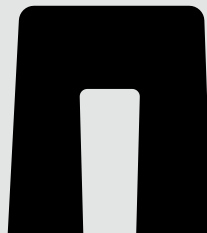

WPU 39 x 36 mm

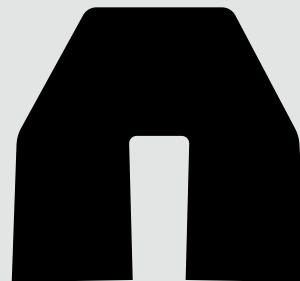

WPC 50 x 25 mm

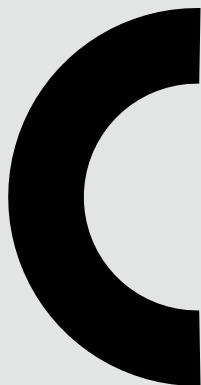

WPUd 39 x 36 mm



WPUv 39 x 36 mm

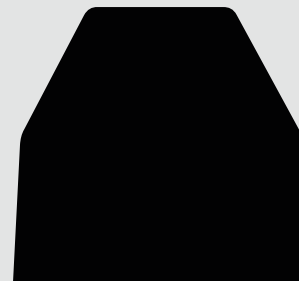

NMC sa

Gert-Noël-Strasse · B-4731 Eynatten

☎ +32 87 85 85 00 · 🖨 +32 87 85 85 11

info@nmc.eu



www.nmc-nomafoam.com